

92-K-59(25) - SPEEDLINE System Data Sheet - Version V1 (24-10-23)

SPEEDLINE 92mm 'C' Stud Partition @600mm Ctrs,
with 2x Knauf 12.5mm Soundshield Plus each side,
25mm APR

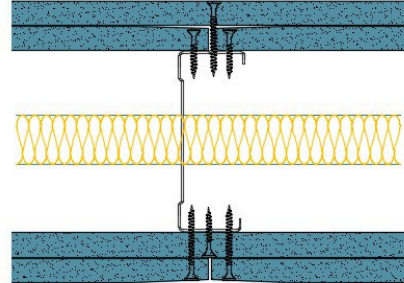

System Performance Breakdown

Fire Resistance:

BS476 Part 22:1987:

Test Ref & Date or Applied Ref & Report:

Max Height:

Thickness:

Duty Grade: BS 5234: Part 2:1992:

Sound Insulation:

60/60 Minutes (Integrity/Insulation).

BRE 208596 - BRE Report P102396-1011B

Refer to Speedline Specification Clause

142 mm. (At Base Track, Excluding Finishes)

Severe - Annexes A-F

55 $R_{w,dB}$, Date Tested or Assessed Against - 70-K-59(25)

Test Code:
H17427AA
Test Date:
27/06/2011

Freq. Hz	R dB
50	21.1
63	17.1
80	15.9
100	30.8
125	36.5
160	40.8
200	42.6
250	46.5
315	51.0
400	53.5
500	56.2
630	59.4
800	62.3
1 000	63.9
1 250	65.2
1 600	67.4
2 000	67.3
2 500	55.2
3 150	50.6
4 000	55.1
5 000	57.0
6 300	
8 000	
10 000	

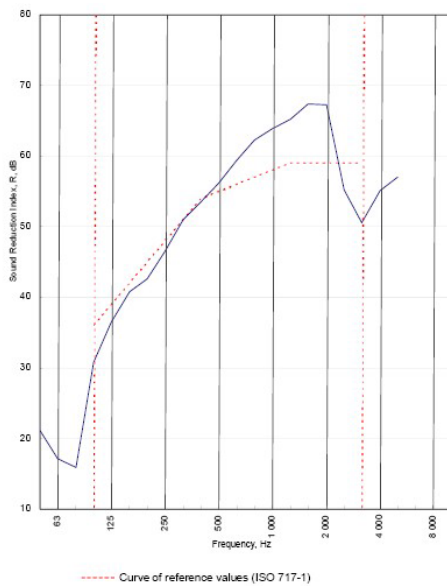



Rating according to BS EN ISO 717-1:1997	R_w (C;Ctr) = 55 (-2;-7) dB
Evaluation based on laboratory measurement results obtained by an engineering method.	Max dev. 8.4 dB at 3 150 Hz
	$C_{50-500} = -9$ dB $C_{50-500} = -8$ dB $C_{100-500} = -1$ dB
	$C_{9-50-315} = -20$ dB $C_{9-50-500} = -20$ dB $C_{9-100-500} = -7$ dB

TESTED AT ONE OF THE UKAS ACCREDITED LABORATORIES BELOW

B.T.C (H-Ref on Graph) 

B.R.E 

AIRO 

S.R.L 

Customer: Metsec plc Hepsec Division

BTC 17427A: Page 9 of 11



SPEEDLINE Drywall Systems, Adsetts House, 16 Europa View, Sheffield Business Park, Sheffield, S9 1XH.

Tel: 0114 231 8030.

Email: enquiries@speedlinedrywall.co.uk

(As per the requirements set out in ISO/IEC 17025:2017 regarding test data the results stated have been carried out by voestalpine Metsec plc as part of the contract to supply Speedline Metal Sections to SIG Plc)

